



ερευνώντας
πραγματικότητες

9 + 9

η διερεύνηση του

K9T * & APV

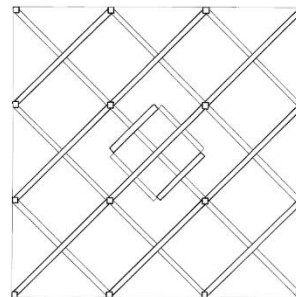
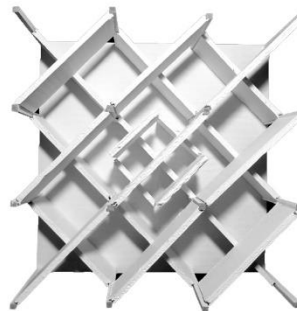
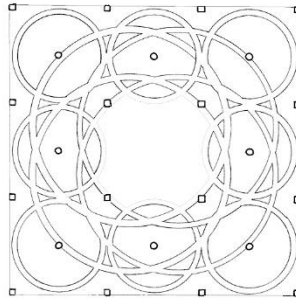
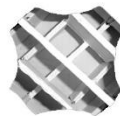
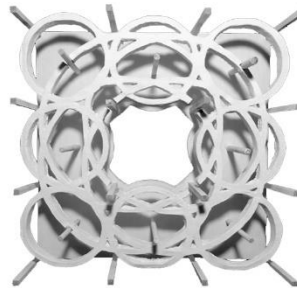
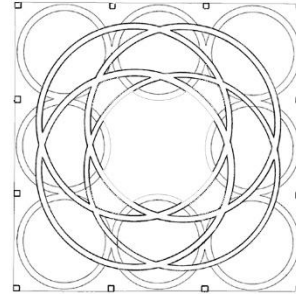
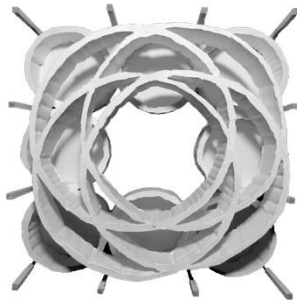
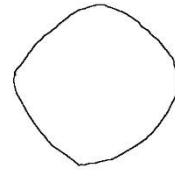
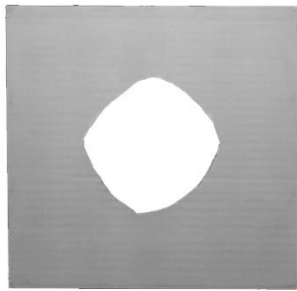

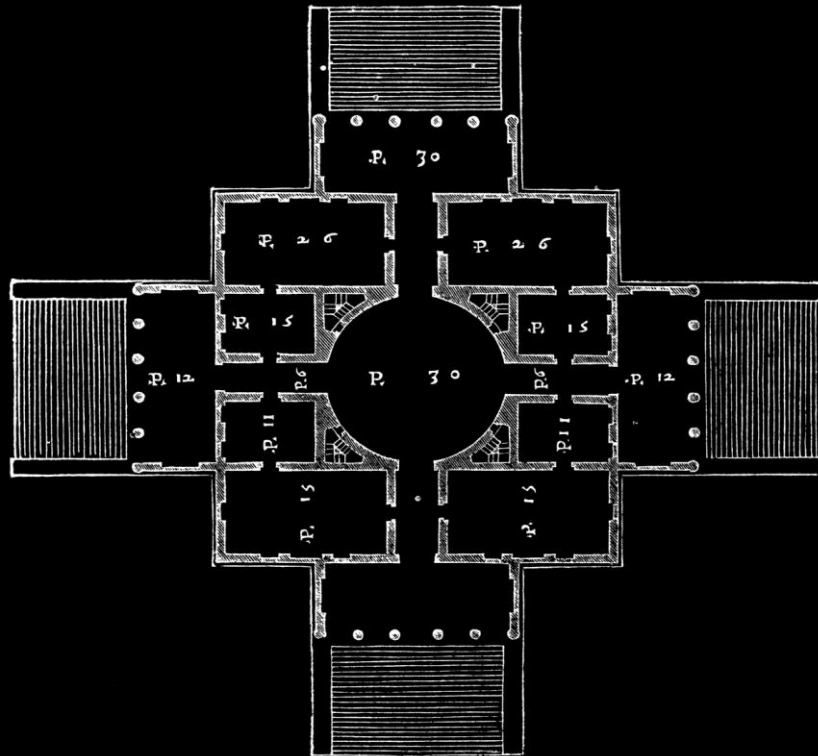

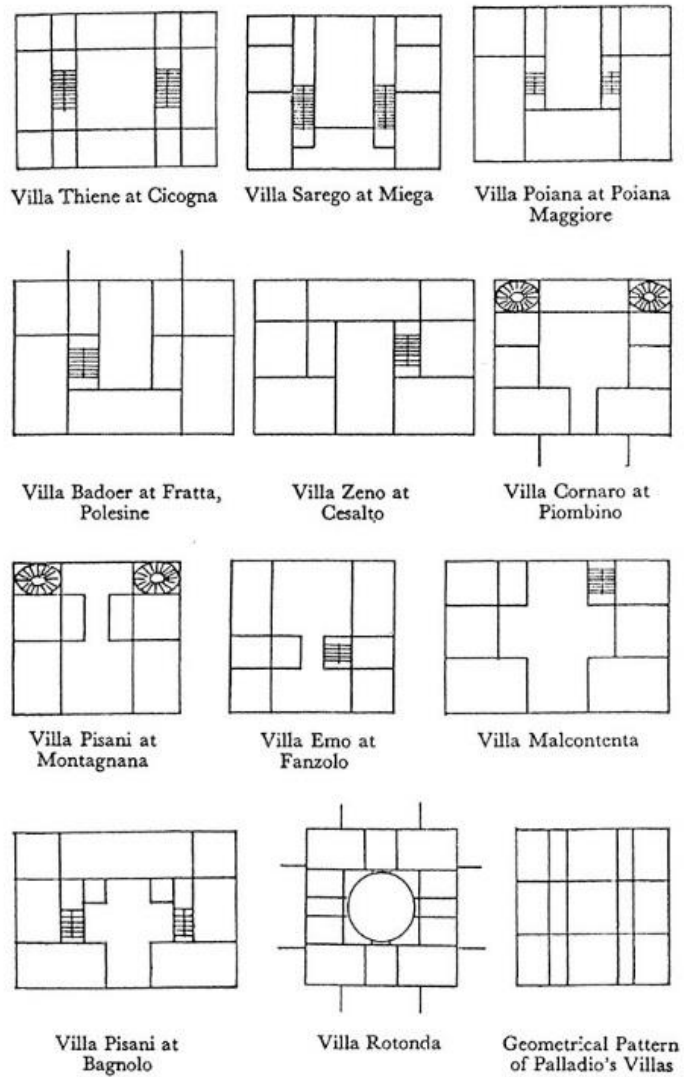
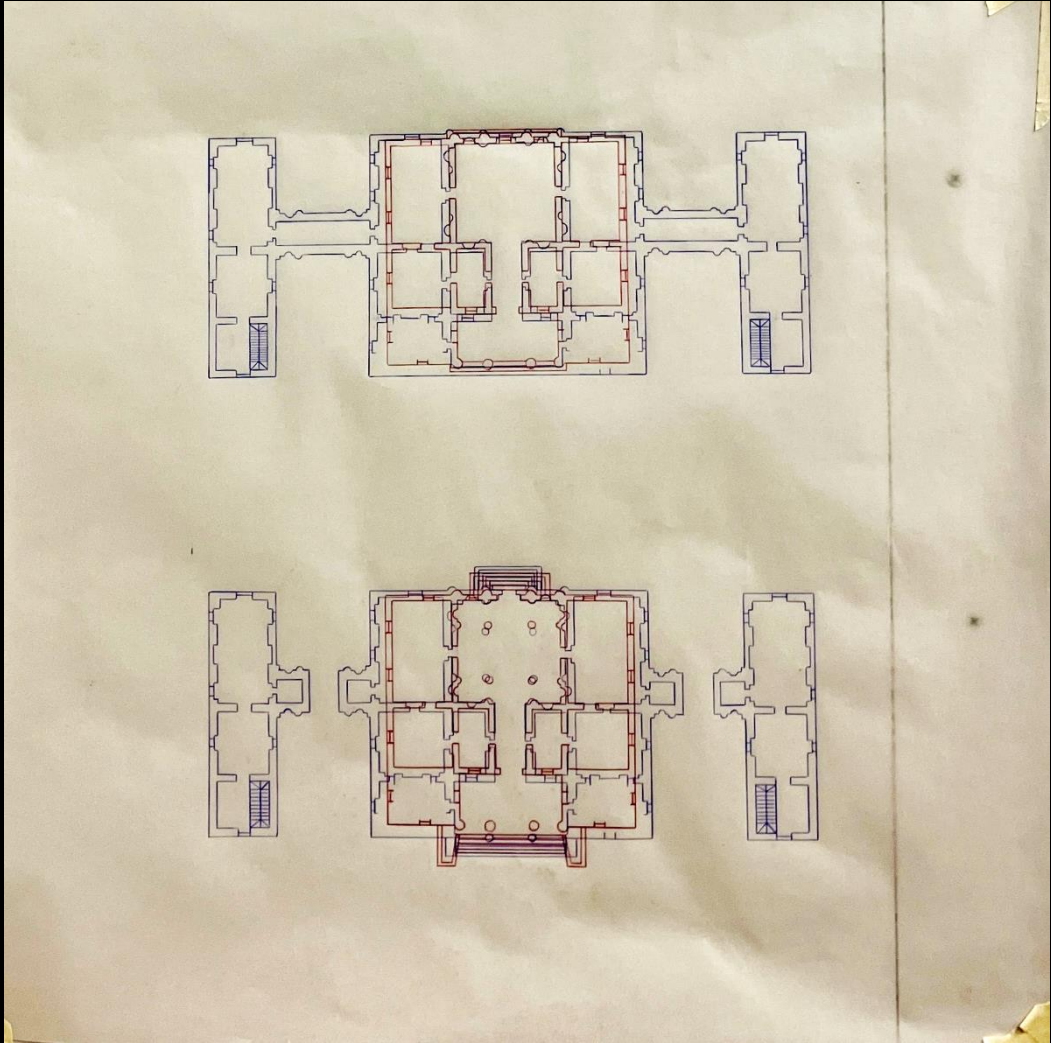
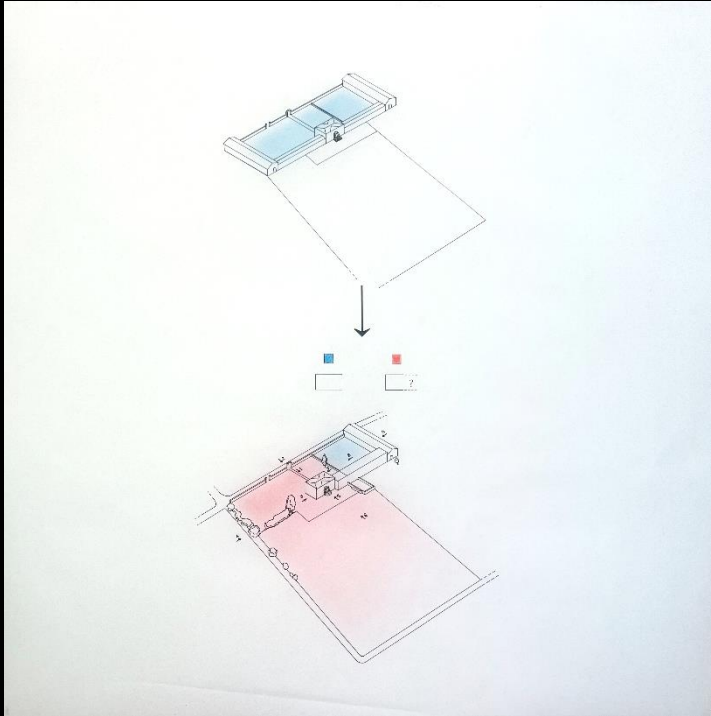

FIGURE 7. Rudolph Wittkower, Palladian Villa Types, in *Architectural Principles in the Age of Humanism* (London, 1952).









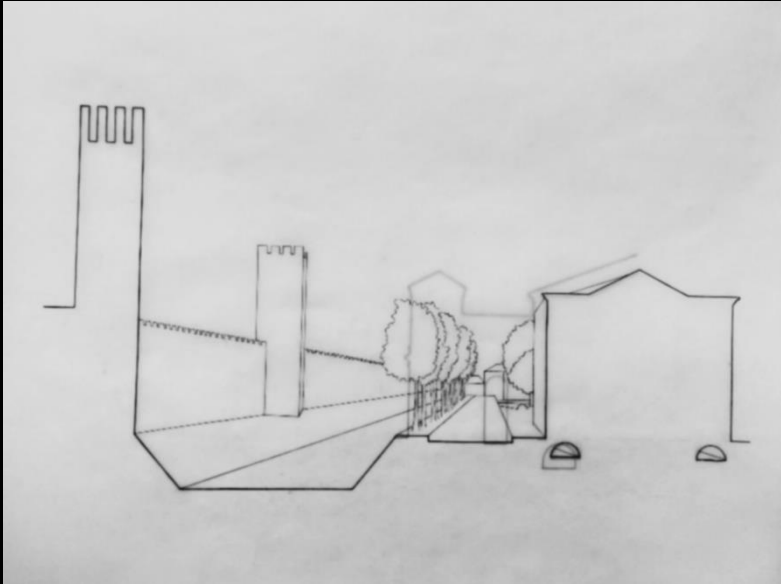

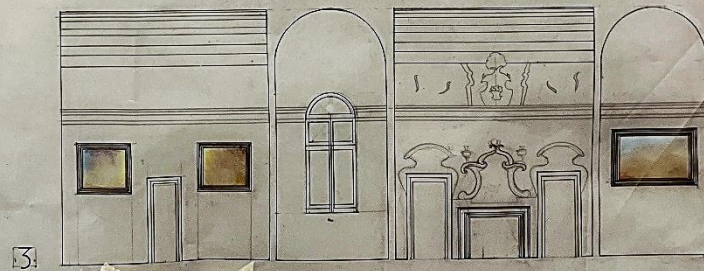
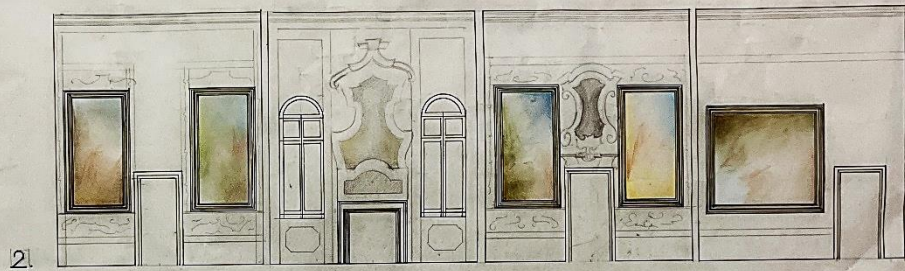
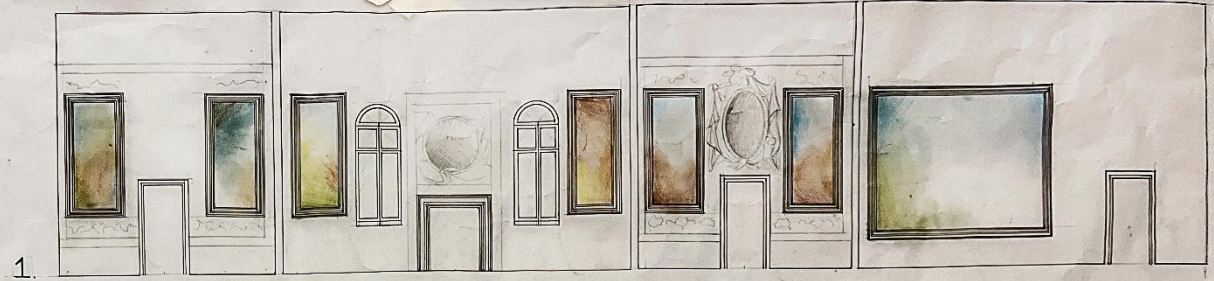
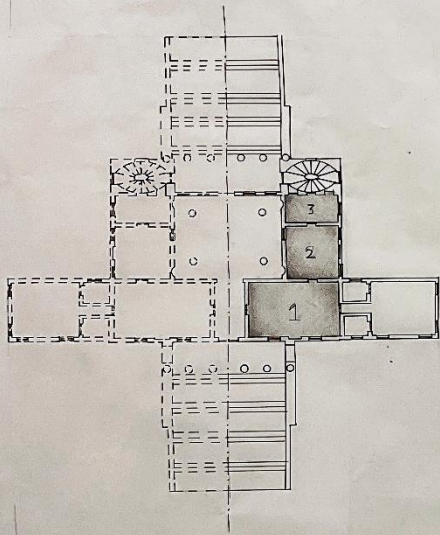



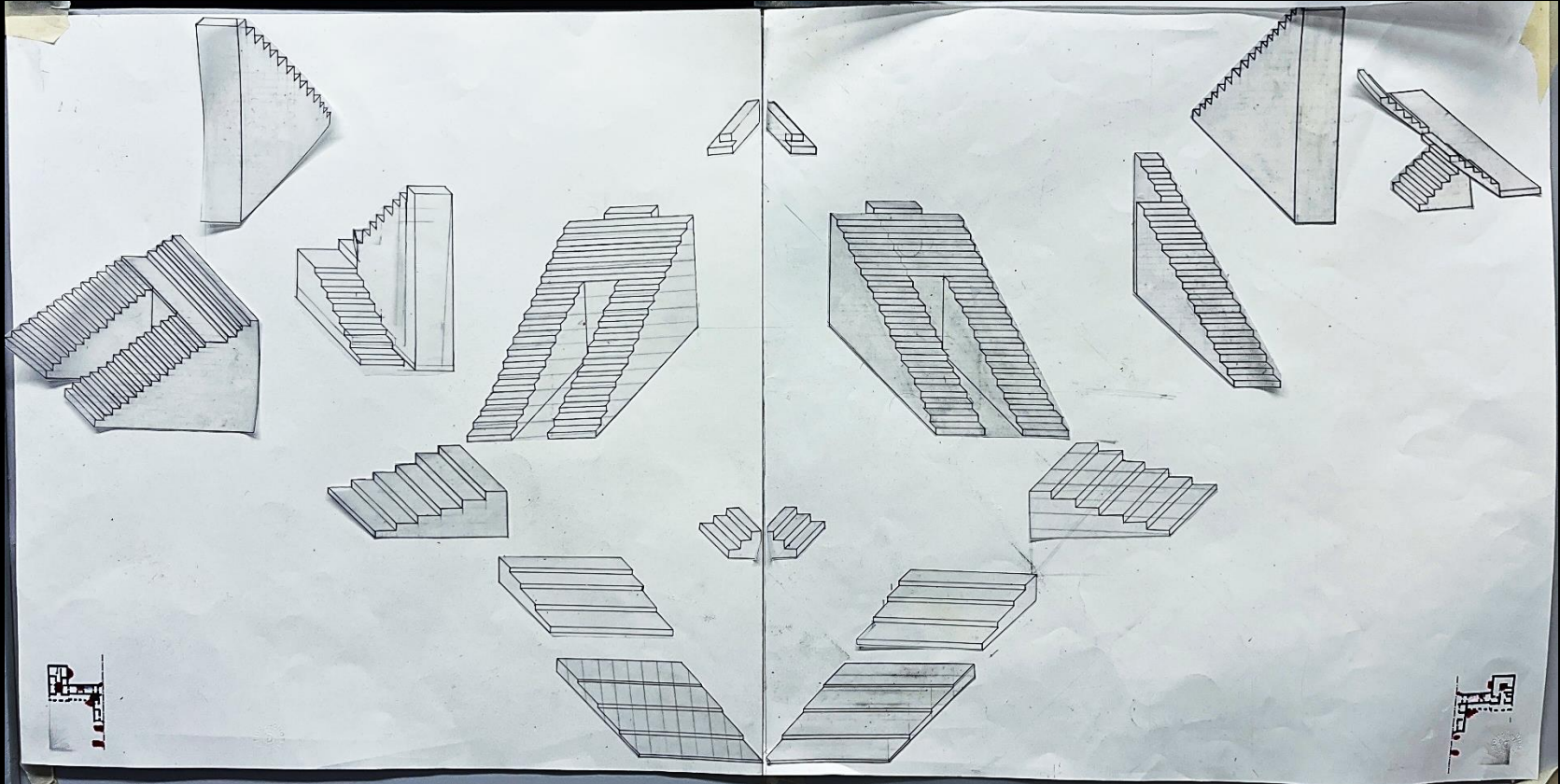





Scale 1:50, including the doorway

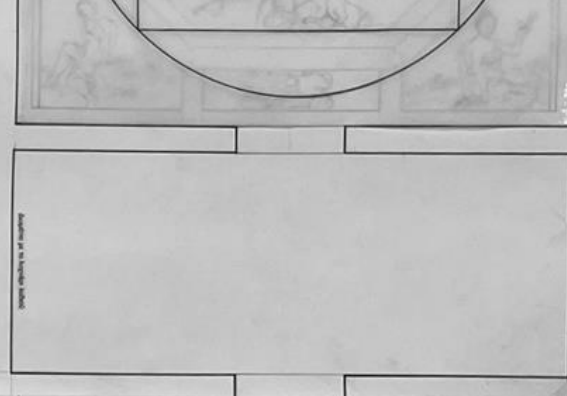

Scale 1:50, including the doorway



Scale 1:50

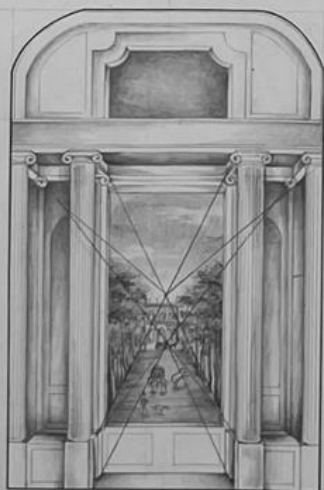
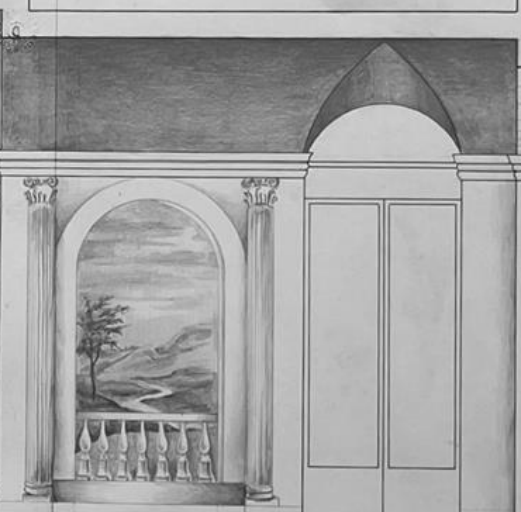
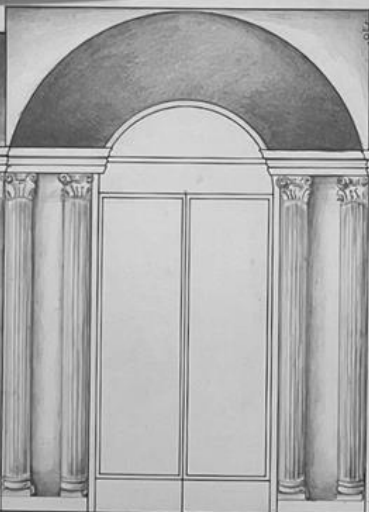

Scale 1:50



K9T*
&
APV

K9T * + APV

θα συντάξετε **9 διαγράμματα**

σε σχέση με

αρχές / αξίες / ιδιότητες

που διερευνήσατε μέσω

του **K9T *** και

της **έπαυλης** του Andrea Palladio

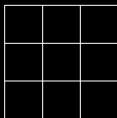

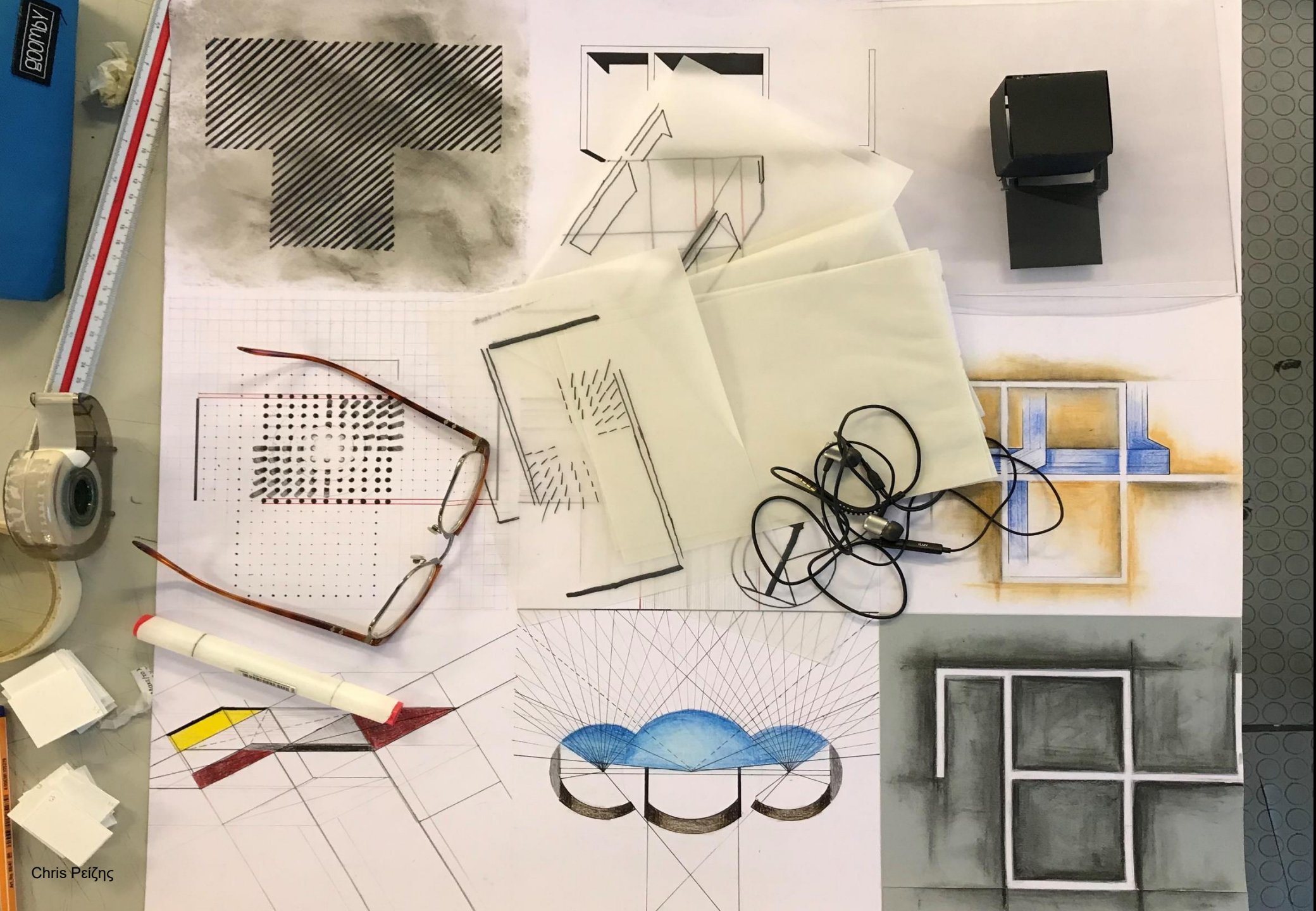

K9T*
&
APV

δομή
ροή
θετικό / αρνητικό
φως / σκιά
κόμβοι / άξονες
επικράτειες
κέντρο / περιφέρεια
οπτικό πεδίο
ειδοποιός διαφορά

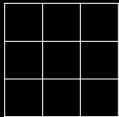

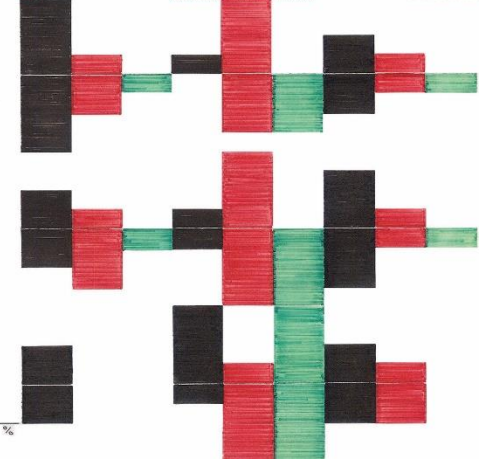
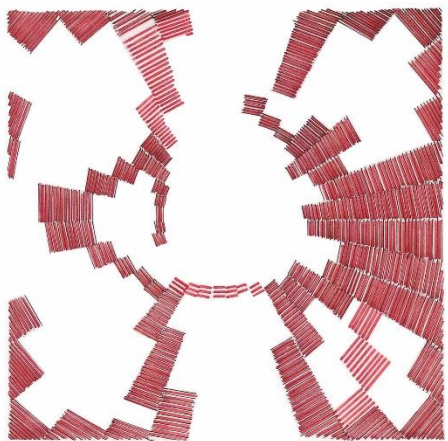
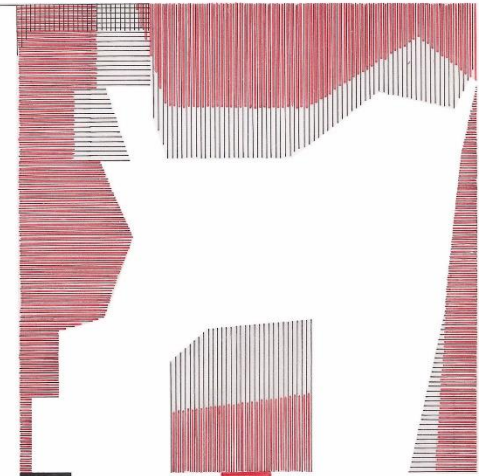
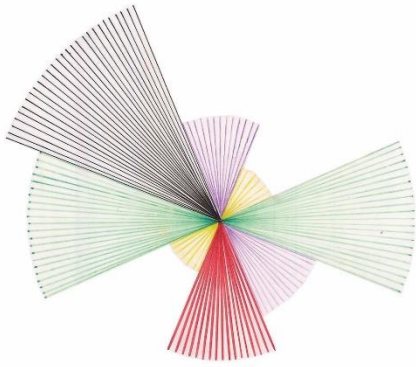
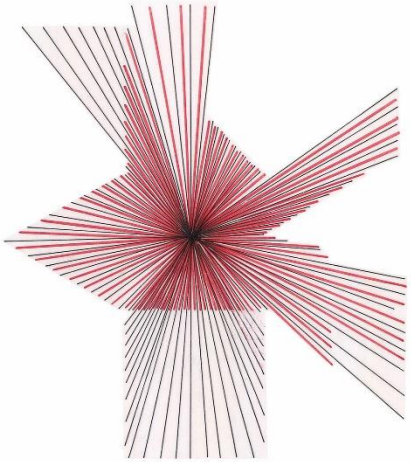
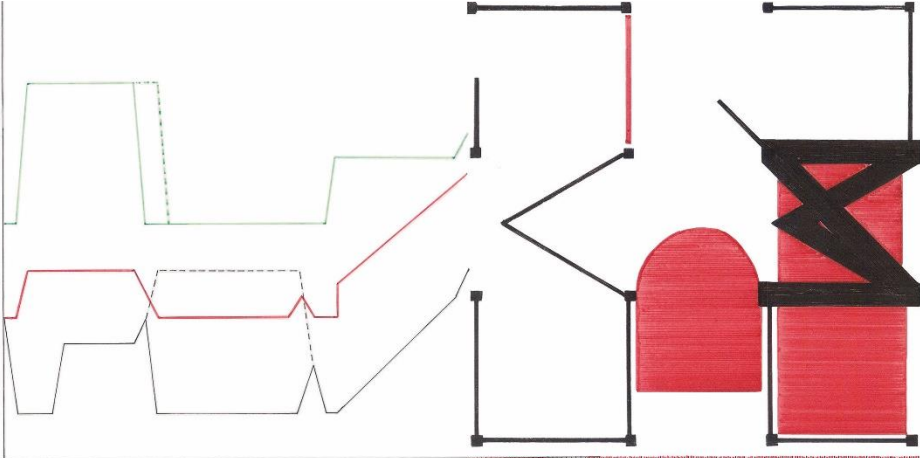
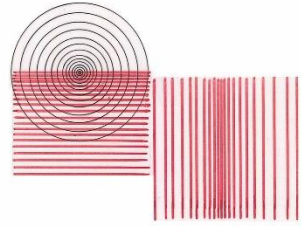

K9T*
&
APV

οργανώστε τα **9 διαγράμματα**

K9T * & APV

βάσει μιας ιεράρχησης που θα ορίσετε οι ίδιοι

σε κάρναβο **9 τετραγώνων**

* σχέδια με μελάνι ή/και μελάνι χωρίς περιθώριο ή λεζάντες

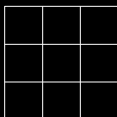

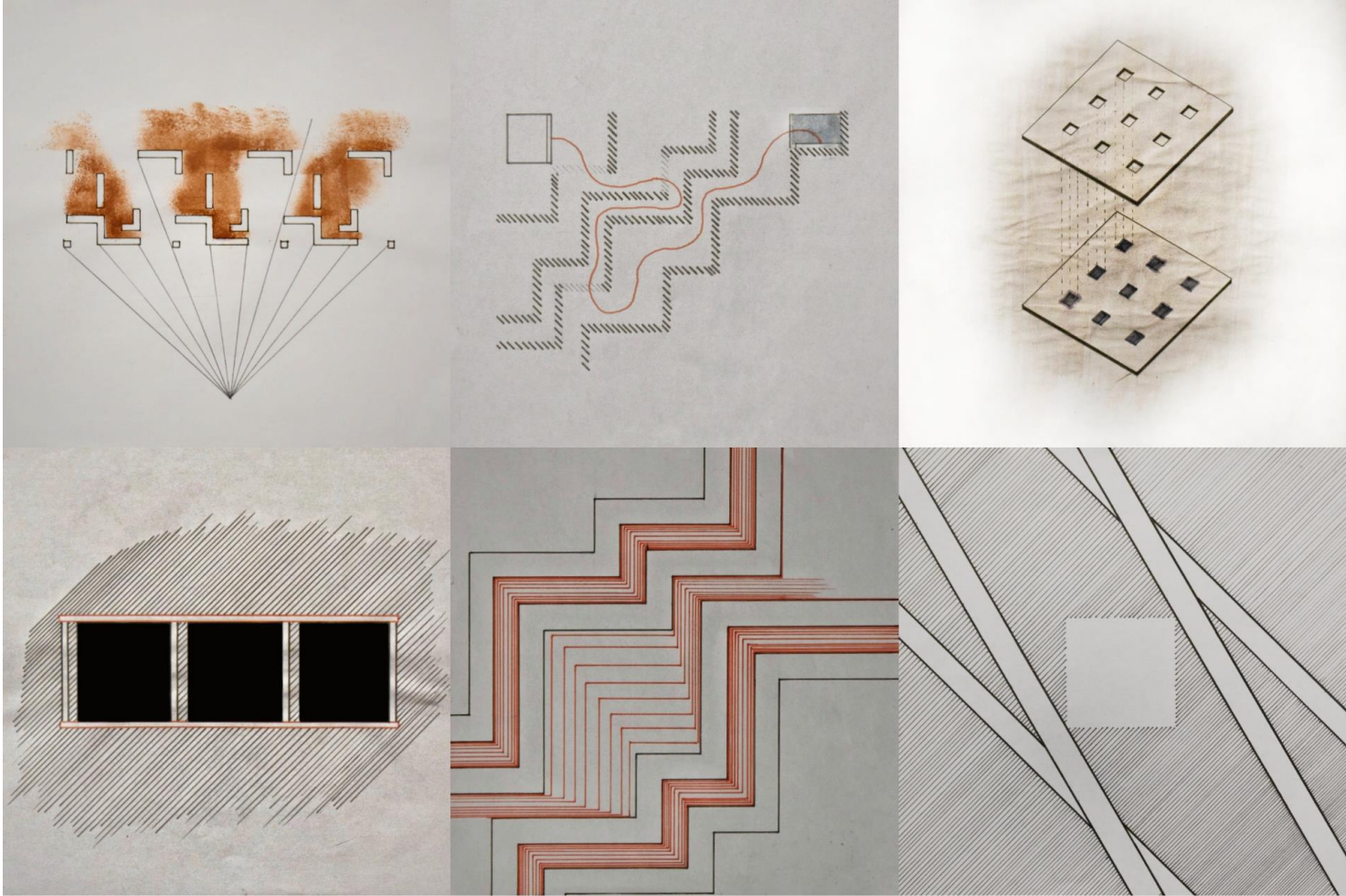

Λάμπρος Πετσάβας

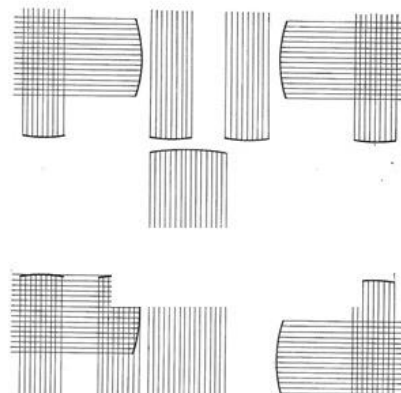
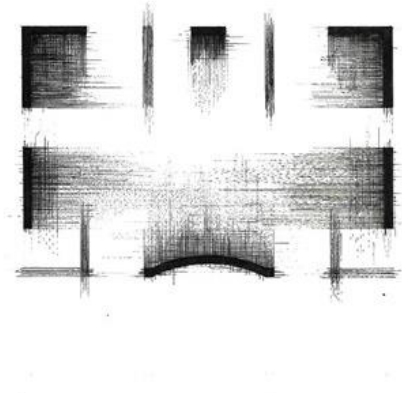
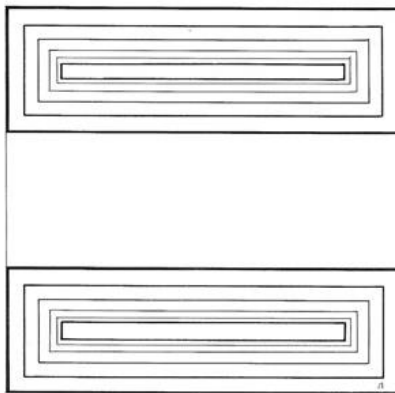
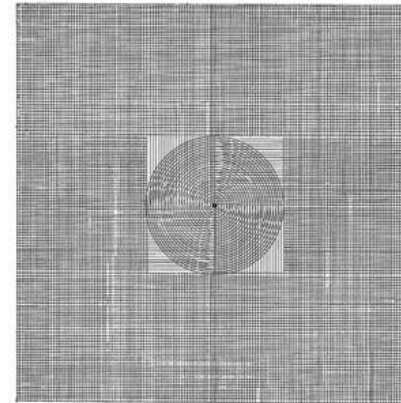
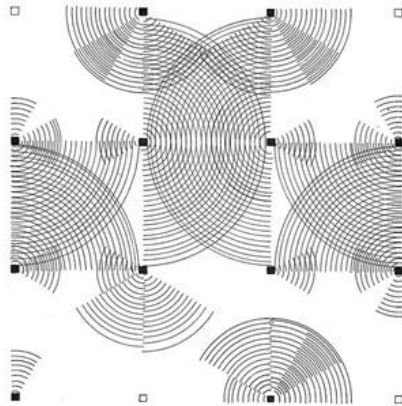
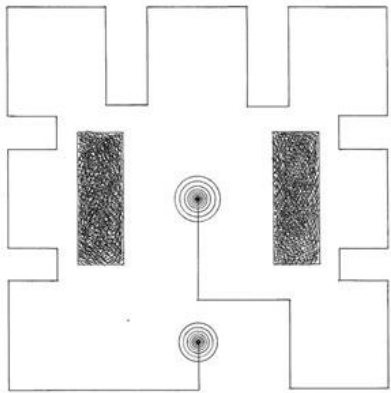
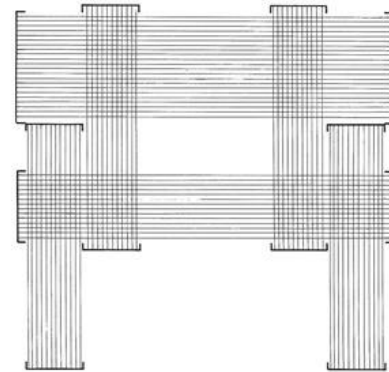
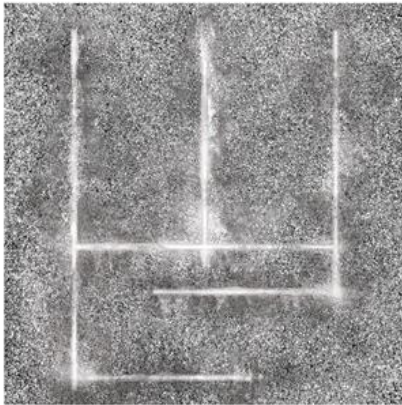
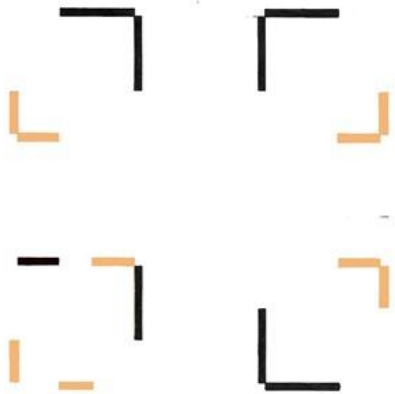

K9T*

σχέδια – διαγράμματα

οργανώστε τα διαγράμματα
σε κάρναβο εννέα τετραγώνων
βάσει μιας ιεράρχησης
που θα ορίσετε
σε δύο πινακίδες 59 X 59
σχέδια με μελάνι

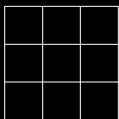

4	9	2
3	5	7
8	1	6

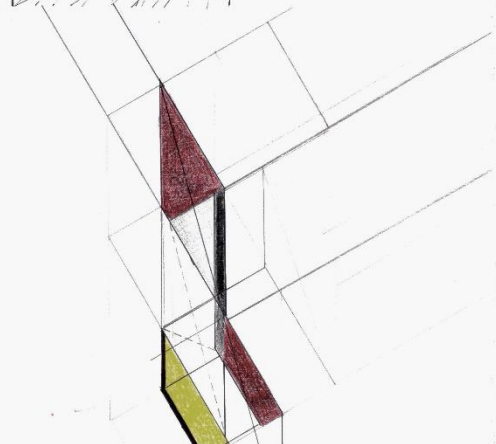
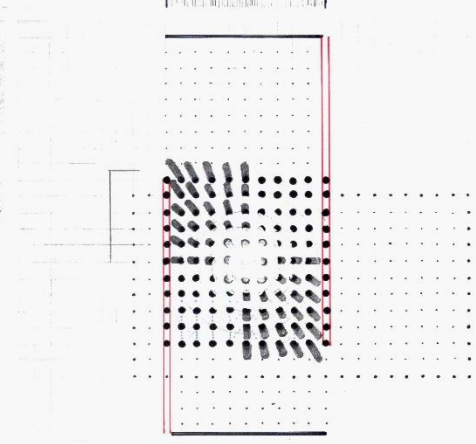
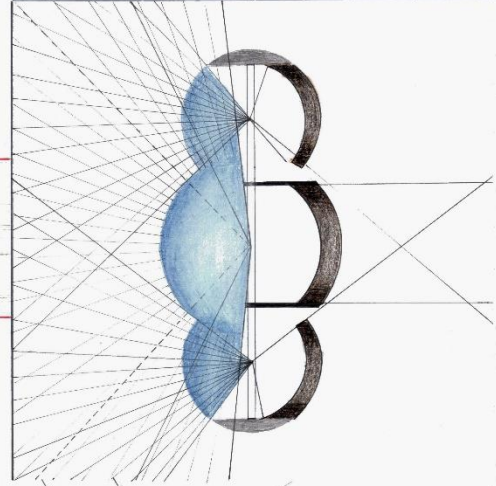
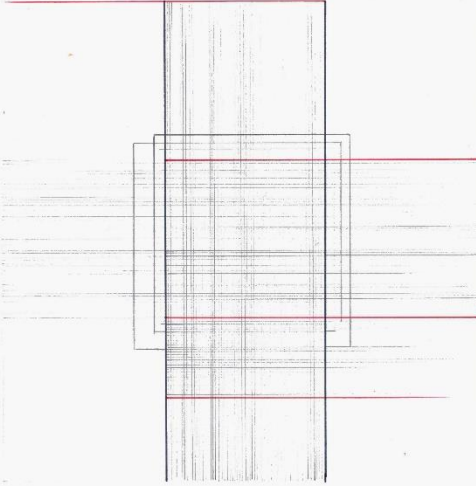
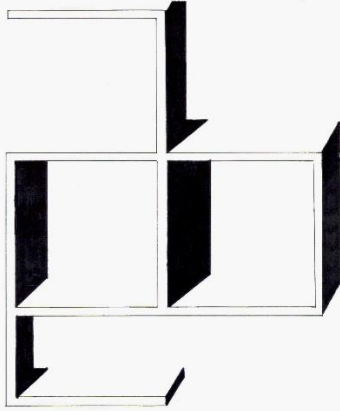
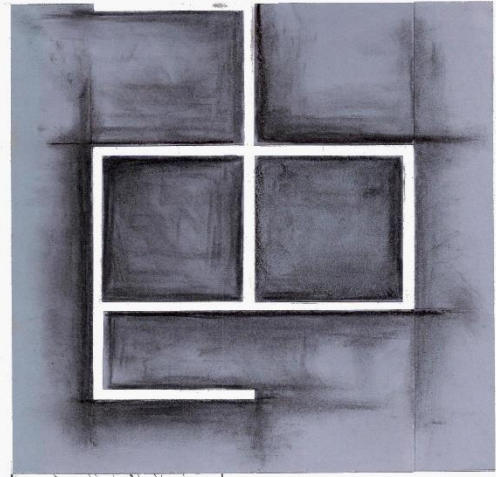
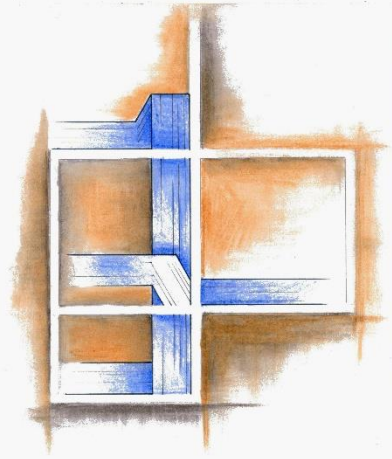
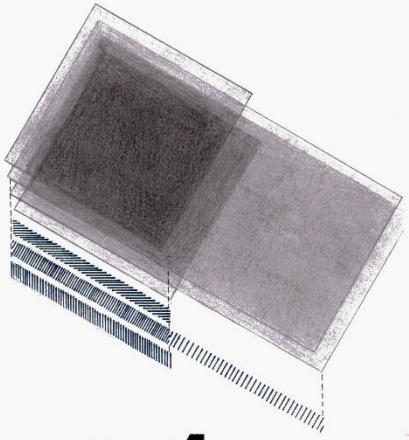

K9T*

για το μάθημα της 25.05.2026
παράλληλα με τα 9 + 9 διαγράμματα,
θα επιμεληθείτε και θα οργανώσετε σε .ppt την έρευνα:

K9T* διερεύνηση & πειραματισμός

διαγράμματα & σημειώσεις διεργασιών

K9T* κατασκευή

φωτογραφικό δοκίμιο διαδικασίας & κατασκευής

K9T* σχέδια & διαγράμματα

1:50 αξονομετρικό, 1:100 τομές, 9 διαγράμματα αρχών

